

# GRANITE STONE

2 cm. Thickness Anti Slip  
Heavy Duty Exterior Porcelain Tile

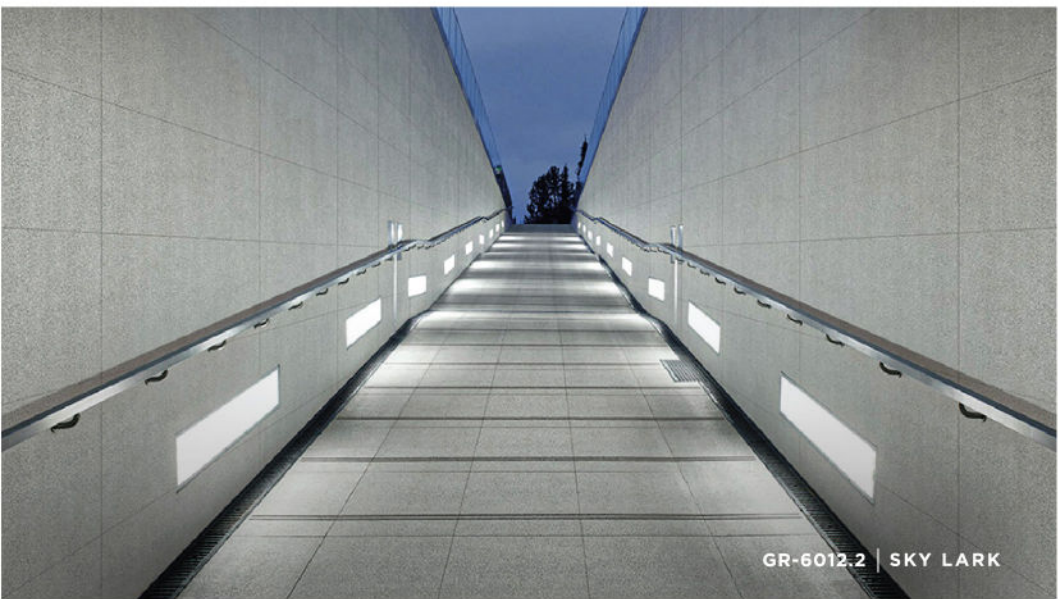

GR-6012.2 | SEAGULL



GR-6012.2 | SKY LARK

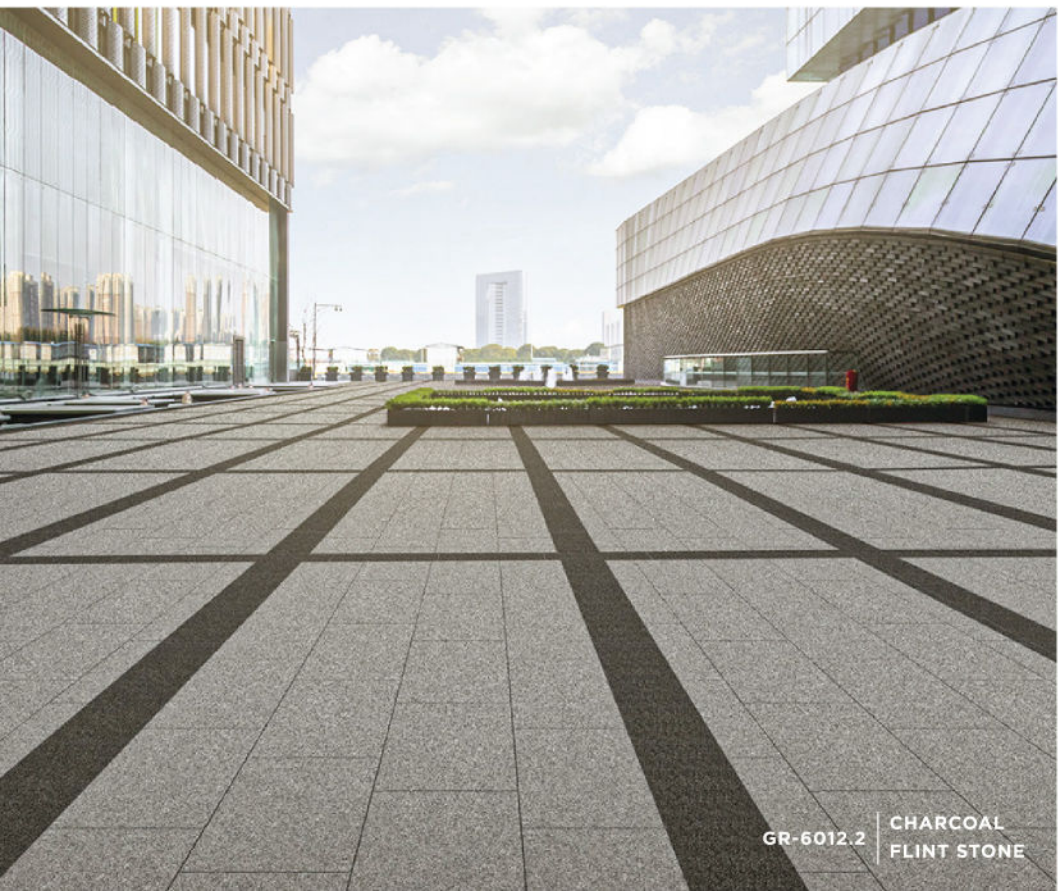

GR-6012.2 | CHARCOAL  
FLINT STONE



**Granite Stone Texture**

A perfect replacement of natural granite stone with the texture and finishes.

**Heavy duty**

Only 2 cm. thickness but has equivalent of 4 cm. granite stone Breaking Strength (10,200N.)

**Homogeneous tile**

A full body color with 0.5% water absorption and Class 3 Deep Abrasion resistance.

**Suitable for exterior area**

High Slip Resistance (R11) to ensure the safety of your love ones in both wet or dry condition.

**COLORS**

**SEAGULL**

**SKY LARK**

**FLINT STONE**

**CHARCOAL**

**YELLOW STONE**

**INDIAN STONE**

CODE : GR-3060.2  
5.56 pcs./sq.m. 4 pcs./ctn

CODE : GR-6060.2  
2.78 pcs./sq.m. 2 pcs./ctn

CODE : GR-6012.2  
1.39 pcs./sq.m. 1 pcs./ctn

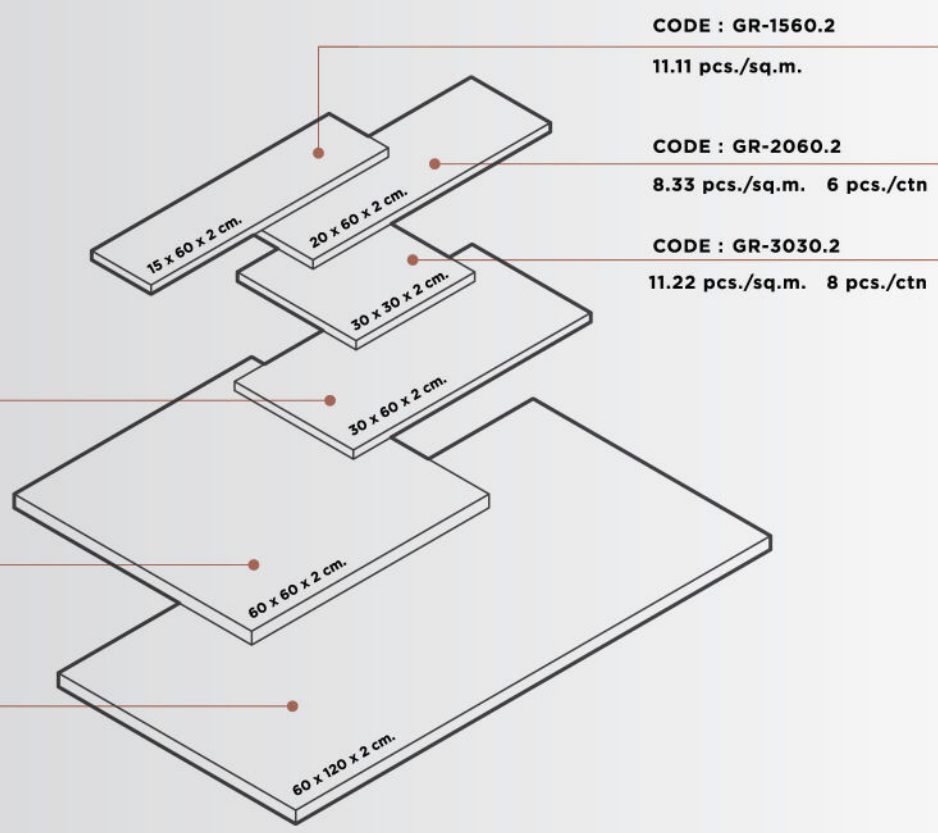

**KENZAI** | ฐ่น : แกรนิตาฟลู  
PORCELAIN & CERAMIC TILES

CODE : GRS-3060.2  
1.67 pcs./meter 4 pcs./ctn

CODE : GRS3-3060.2  
1.67 pcs./meter 4 pcs./ctn

CODE : GRL-3060.2  
1.67 pcs./meter 4 pcs./ctn

